

PROPOSED FLOOR PLAN



**PHASE 1 - REMODELING
COUNSELING &
RESOURCE OFFICES**
3,200 SF



**PHASE 2 - ADDITION
GYMNASIUM &
CLASSROOM**
30,305 SF

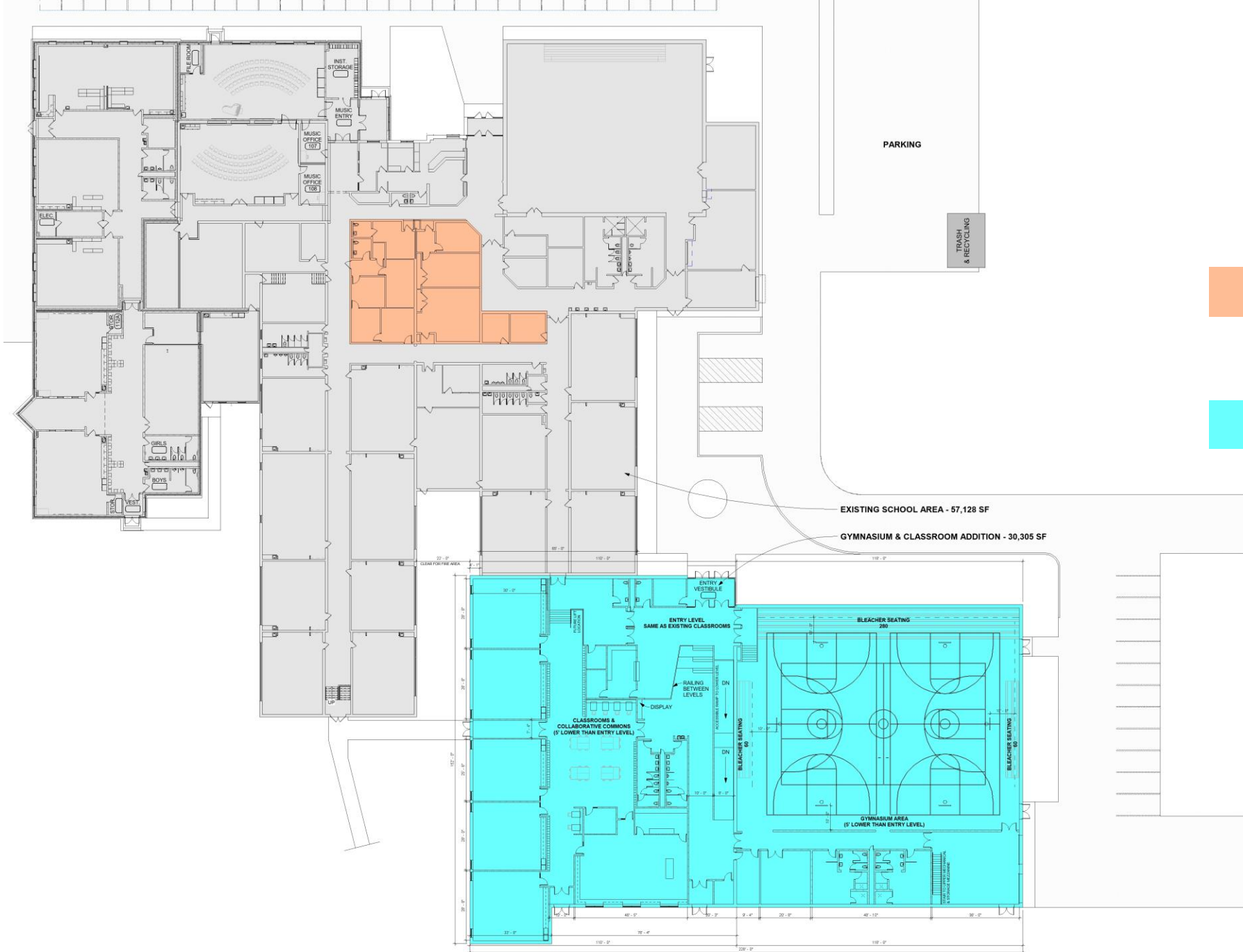

PROPOSED FLOOR PLAN

 **PHASE 1 - REMODELING
COUNSELING &
RESOURCE OFFICES
3,200 SF**

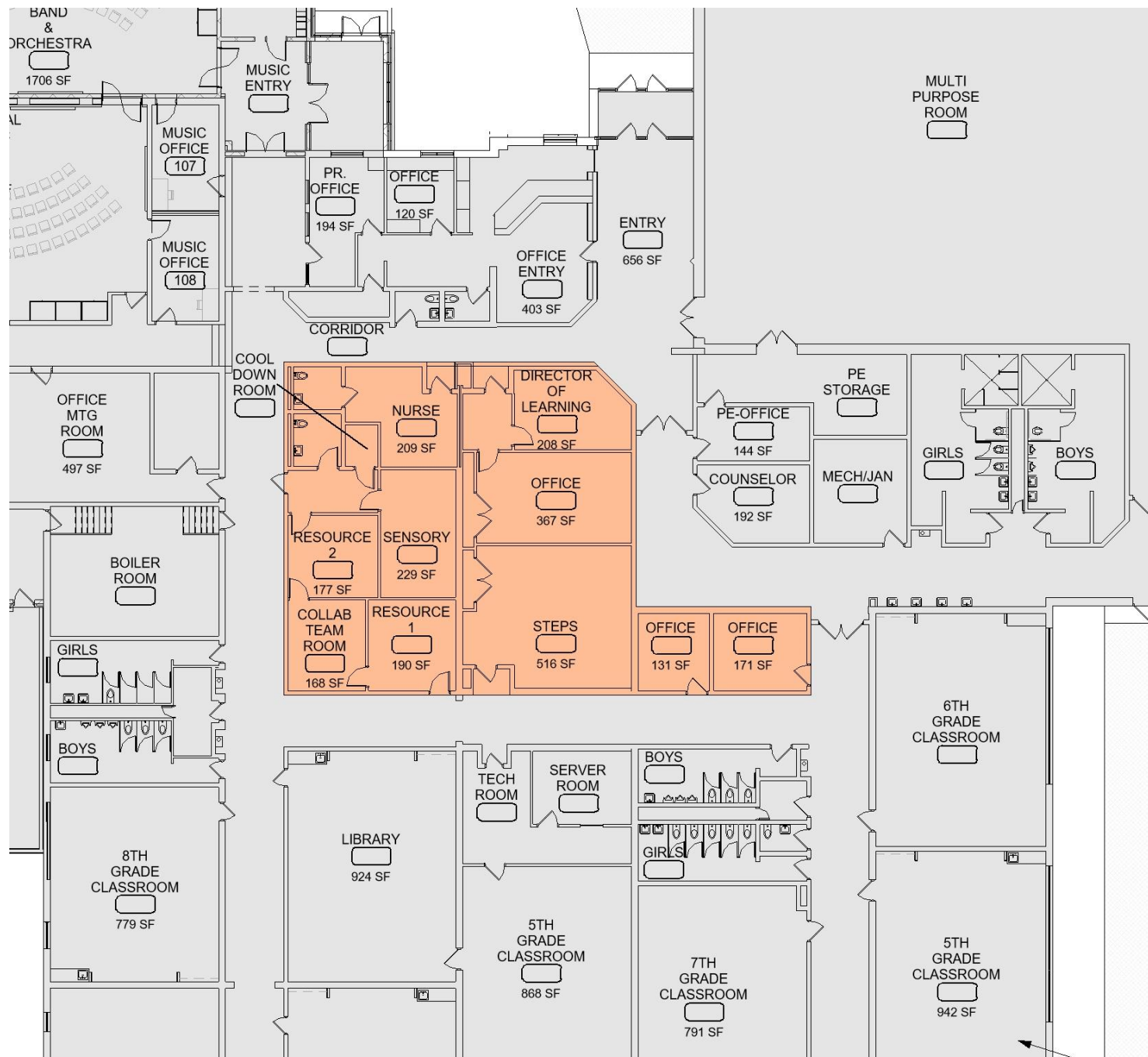

OLESON
+ HOBBI
ARCHITECTS
LLC

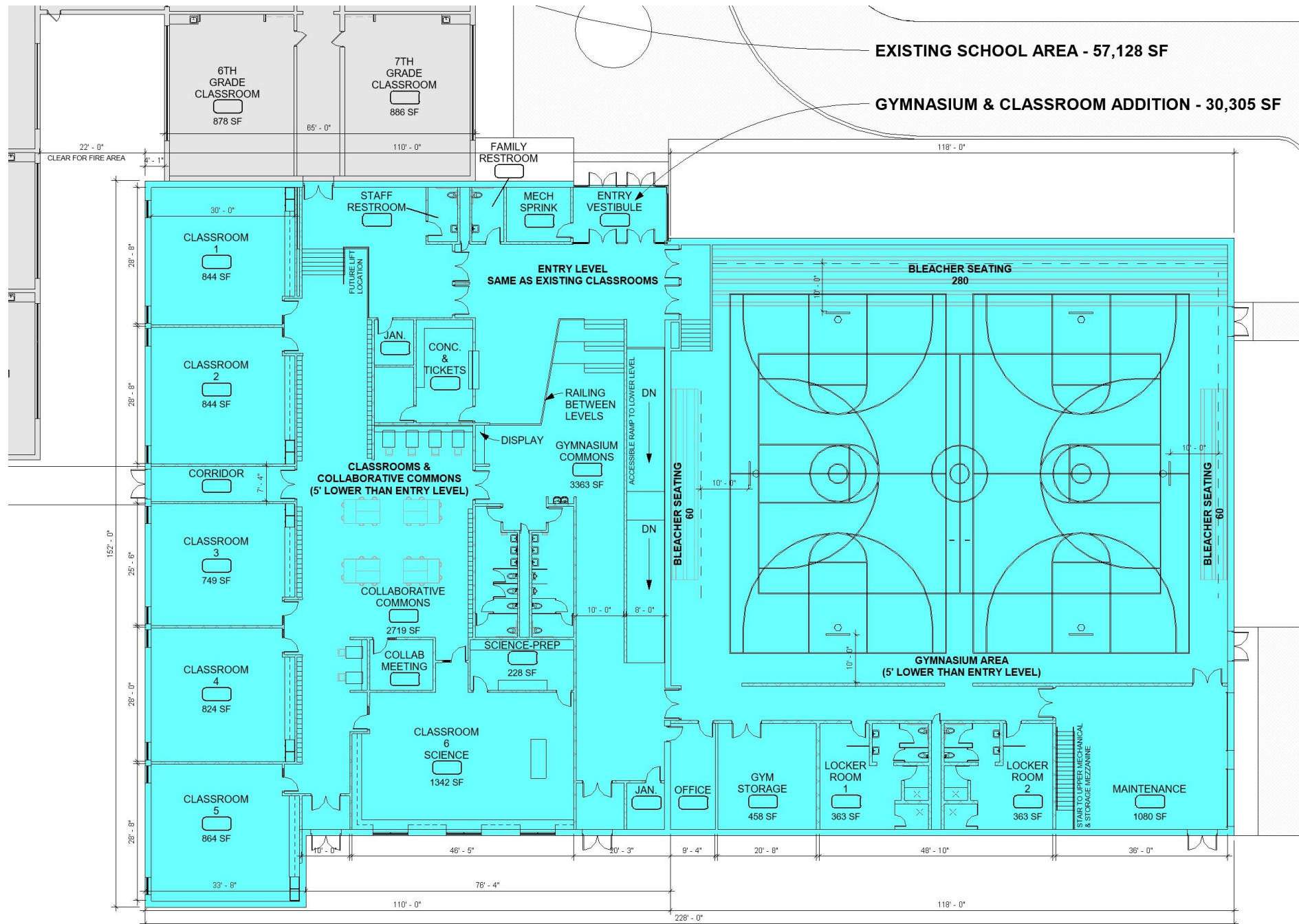

ESTIMATED CONSTRUCTION COSTS – 2024 (2025 add 5%)

Orange City Christian School – Phase 1: Remodeling - Phase 2: Gymnasium & Classroom Addition

▪ Counseling & Resource Offices Remodeling – Phase 1:	3,200 sf	\$ 300,000	to	\$ 350,000
▪ Remodeled STEP Resource Room with support spaces				
▪ Collaborative Resource Areas				
▪ Remodeled Nurses Area with Restroom				
▪ Gymnasium & Classroom Addition – Phase 2:	30,305 sf	\$ 7,425,000	to	\$ 8,900,000
▪ Gymnasium – High School Basketball Court & Middle School Courts	(14,917 sf)	(\$3,655,000)	to	(\$4,381,000)
▪ Science Lab with Prep Room, Classrooms & Collaboration Spaces	(15,388 sf)	(\$3,770,000)	to	(\$4,519,000)
▪ Furniture, Fixtures & Equipment (FF&E)		\$ 100,000	to	\$ 150,000
▪ Site Grading, Stormwater Pond and Parking Lots		\$ 300,000	to	\$ 350,000
▪ Site Sidewalks		\$ 40,000	to	\$ 48,000
▪ Total Construction Costs		\$ 8,165,000	to	\$9,798,000
▪ Project Contingency (10% - 12%)		\$ 816,500	to	\$ 1,175,760
▪ Total Construction Cost with Contingency Range		\$ 8,981,500	to	\$ 10,973,760
▪ Total Professional Design Fees (4.5% of Construction Cost)		\$ 404,168	to	\$ 494,000
TOTAL ALL INCLUSIVE PROJECT RANGE - PHASE 2:		\$ 9,385,700	to	\$ 11,467,800
		75%		\$ 7,039,275 to \$ 8,600,850
		<u>Cash on Hand/Cetera/Pledges</u>		<u>-\$ 3,345,800 - \$ 3,345,800</u>
		Needed to Start		\$ 3,693,475 to \$ 5,255,050